

When the app is opened it will go thru a series of directions.

App is based on body weight, calculate your daily calorie of sport



Male

Female

1. It begins with the gender.



60 kg lbs

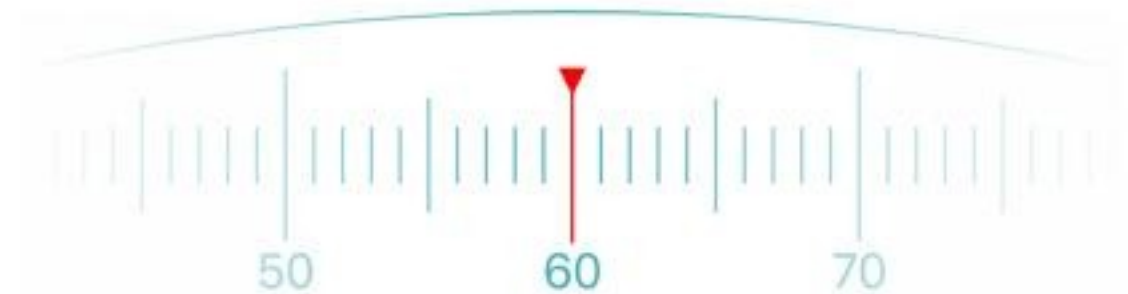

2. After the gender a few more questions will appear

3. Swipe from right to left until you see Start

4. Click start

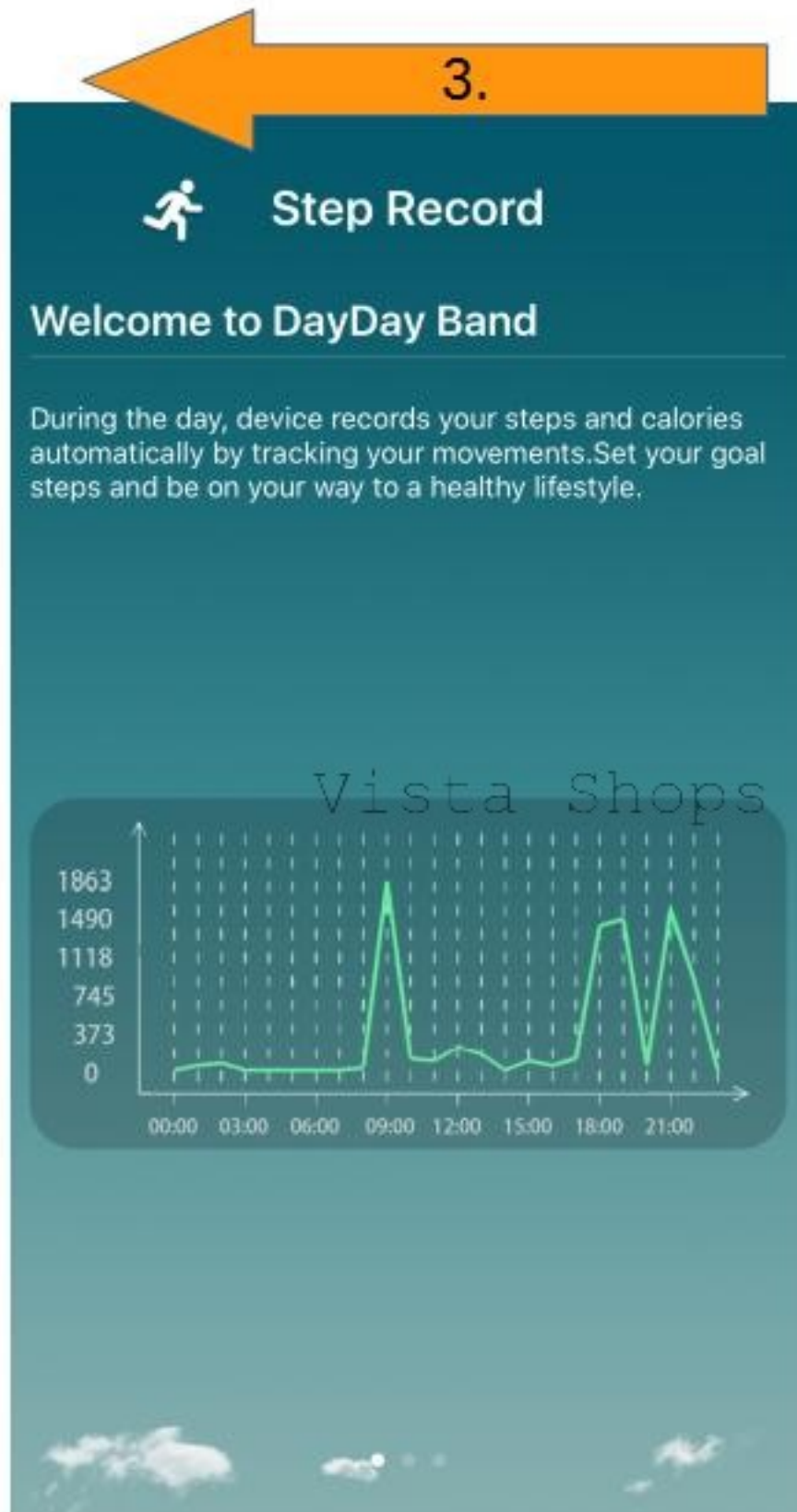

Permissions For Alerts, etc.

- To use certain features allowing **'Notifications'** is needed
- If you **do not** want to use the alert features then choose **'Don't Allow'**

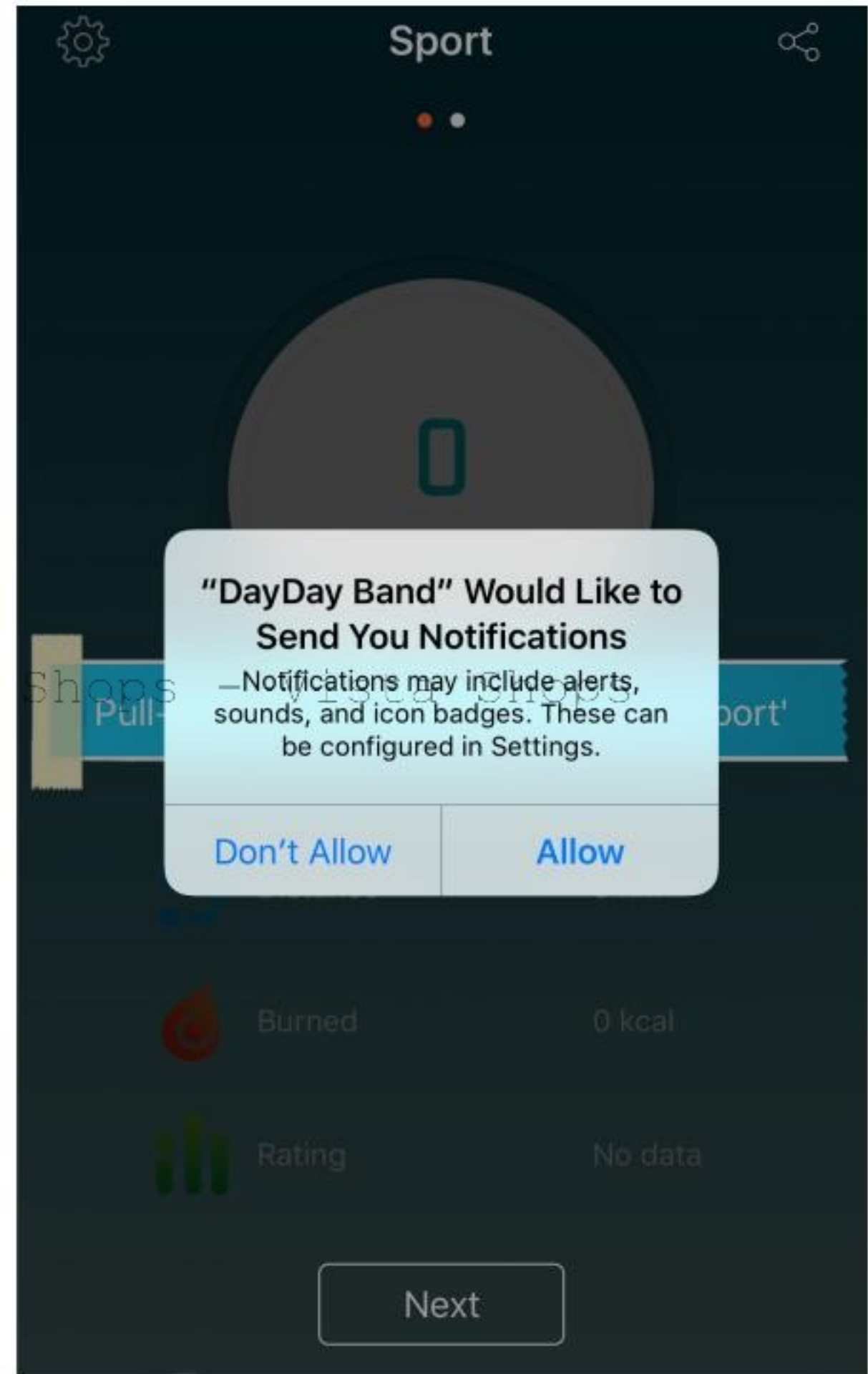

Pulling down on the screen, on a empty area, will sync the watch and phone.

A message will appear just above "Sport"

Vista Shops - Vista Shops - Vista Shops

This is a preview screen that appears when the app is opened for the first time.

Click on **NEXT** to proceed

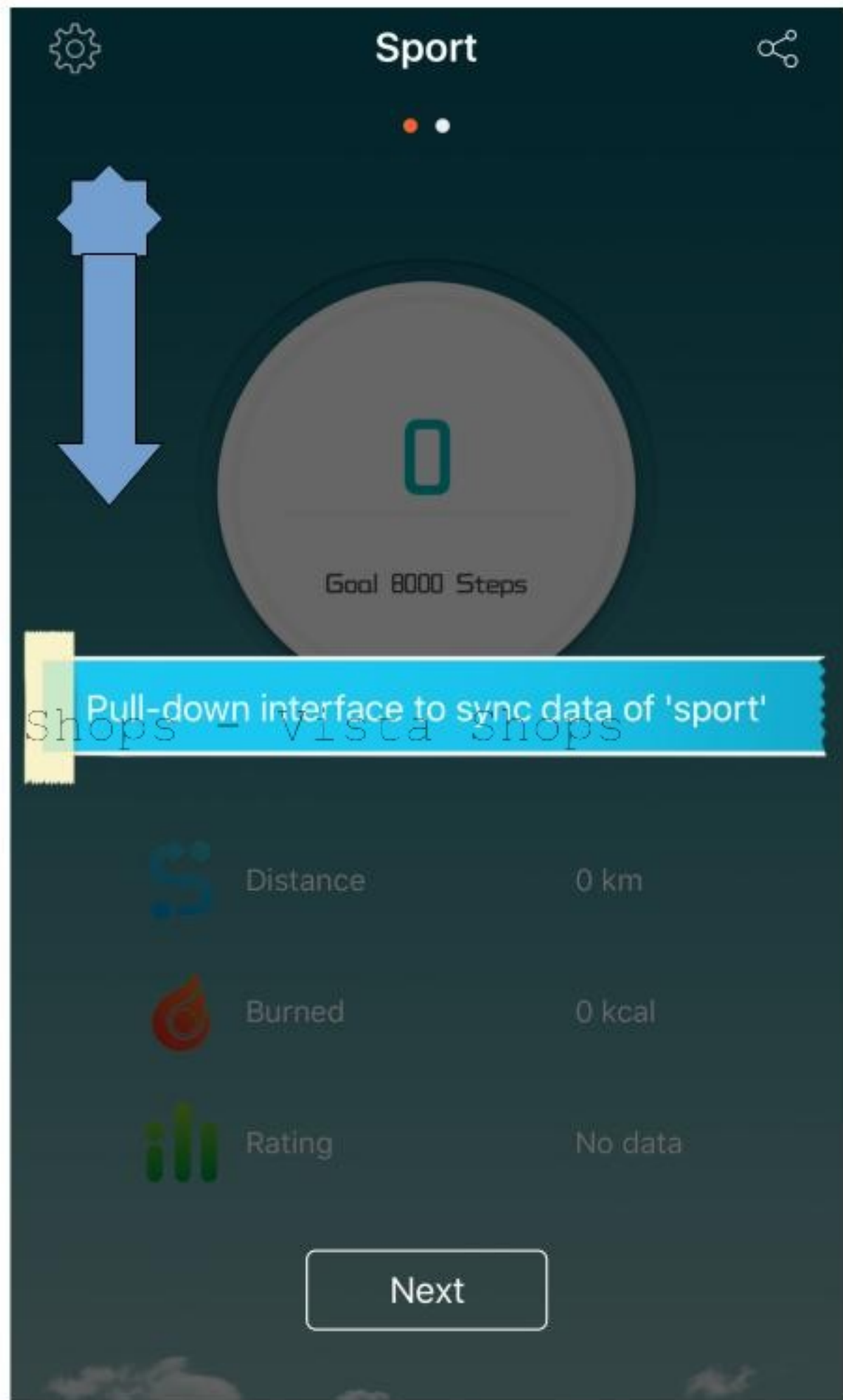

Binding Band



If you do not see DayDay Band then pull down on the screen white lower half of the screen until DayDay Band appears.

When DayDay Band shows click on it once.
(if it says Disconnect it means it is Disconnected)

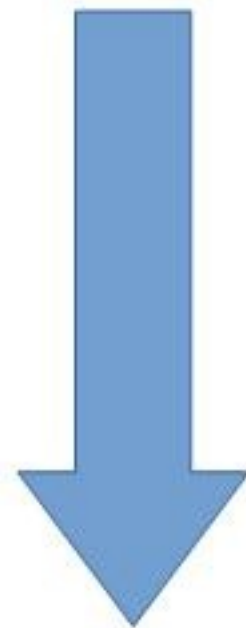
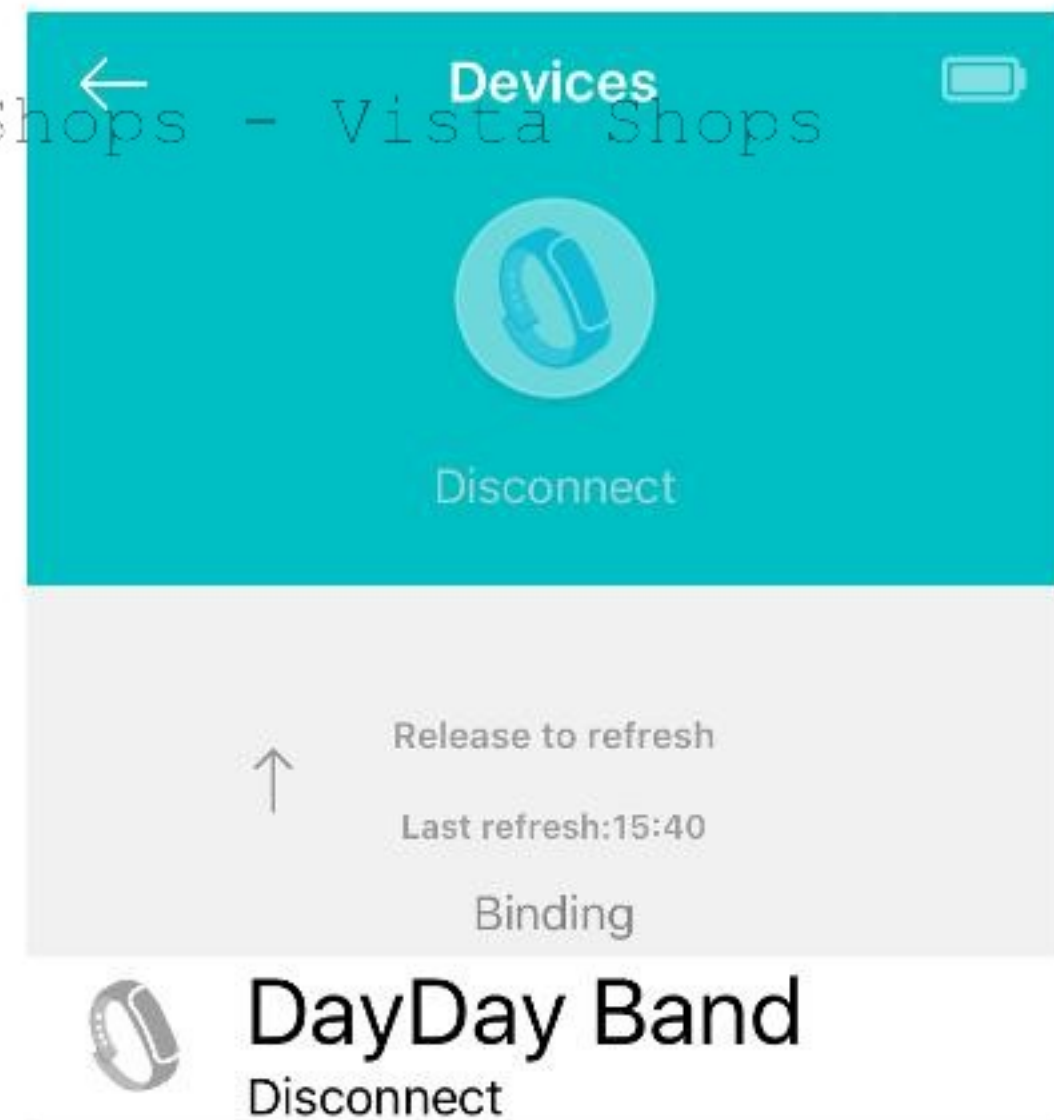

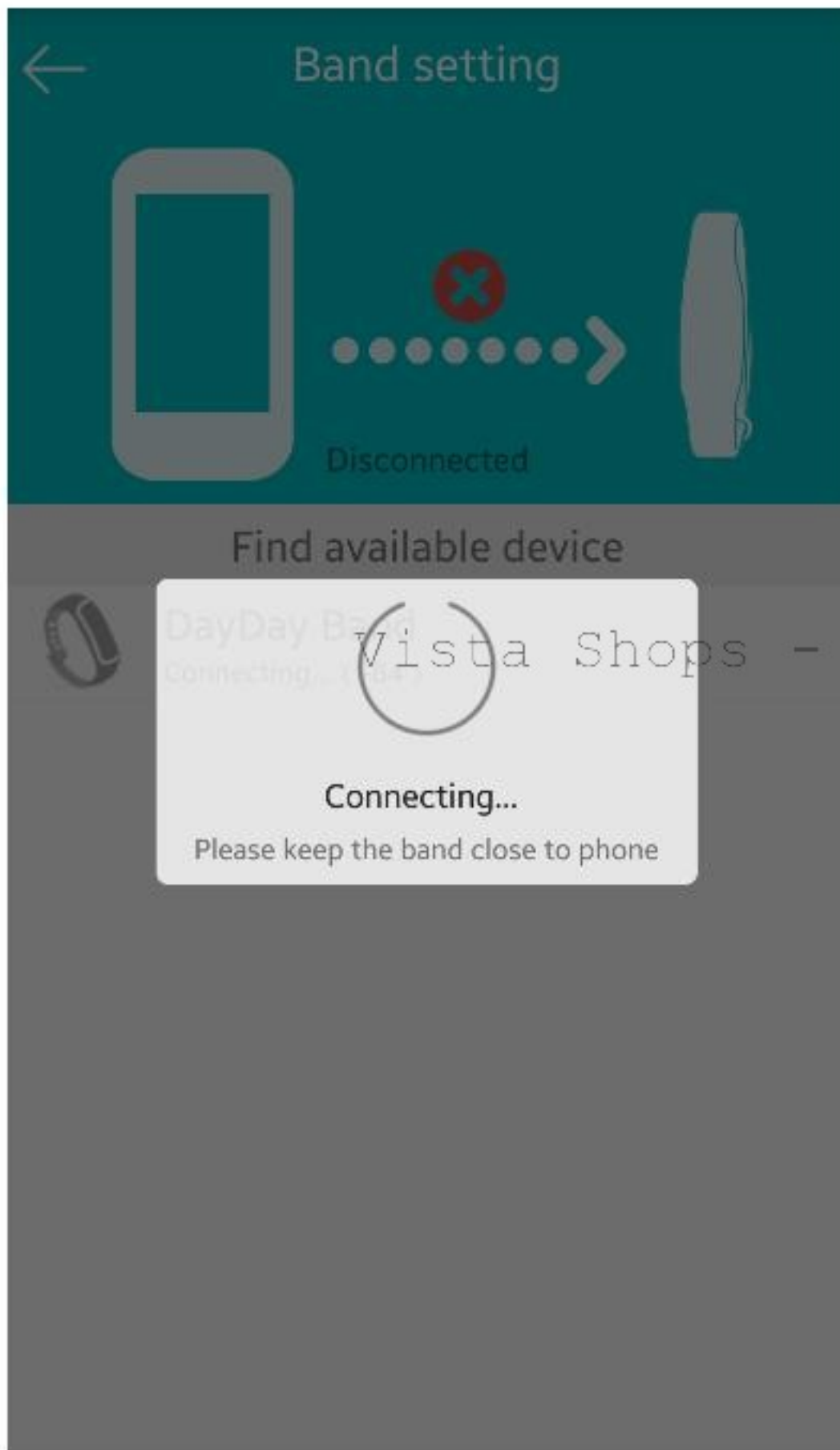

After pressing Day Day Band it will attempt to connect.

After the band is connected the red X changes to a check mark.

The DayDay Band will turn blue and will state Connected.



Connecting the device

- After going to the **Settings**, click on **Devices**.

1. Place finger on the white empty lower half of the screen and pull **Down** on the screen and '**Release to refresh**' should appear.

2. Remove the finger and the app will search for the Mini.

3. After a few moments DayDay Band should appear.

4. Click on DayDay Band and it will begin the syncing.

If it says Disconnect then it is not connected.

DayDay Band should turn blue after being connected.

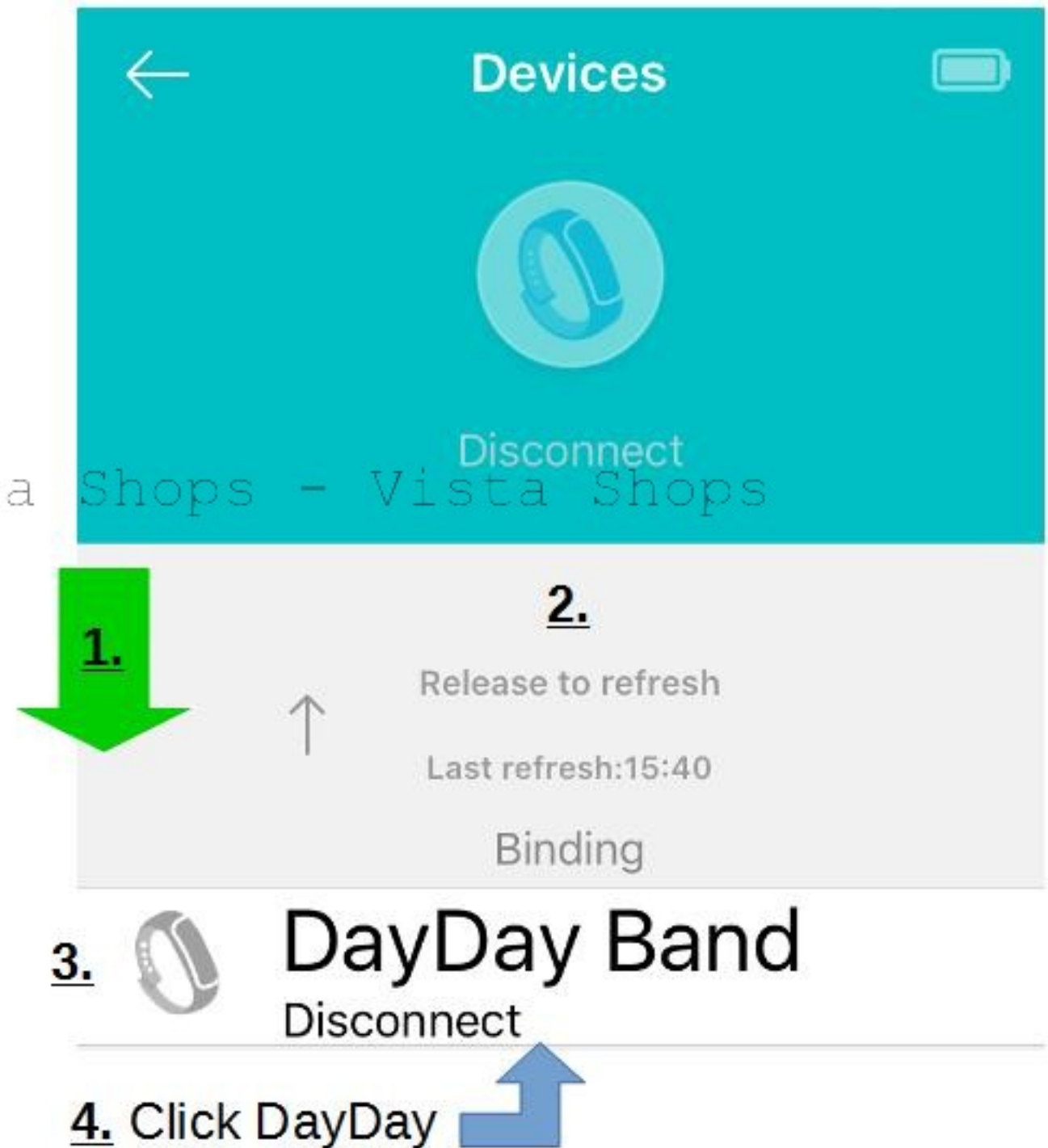

Opens the settings of the application

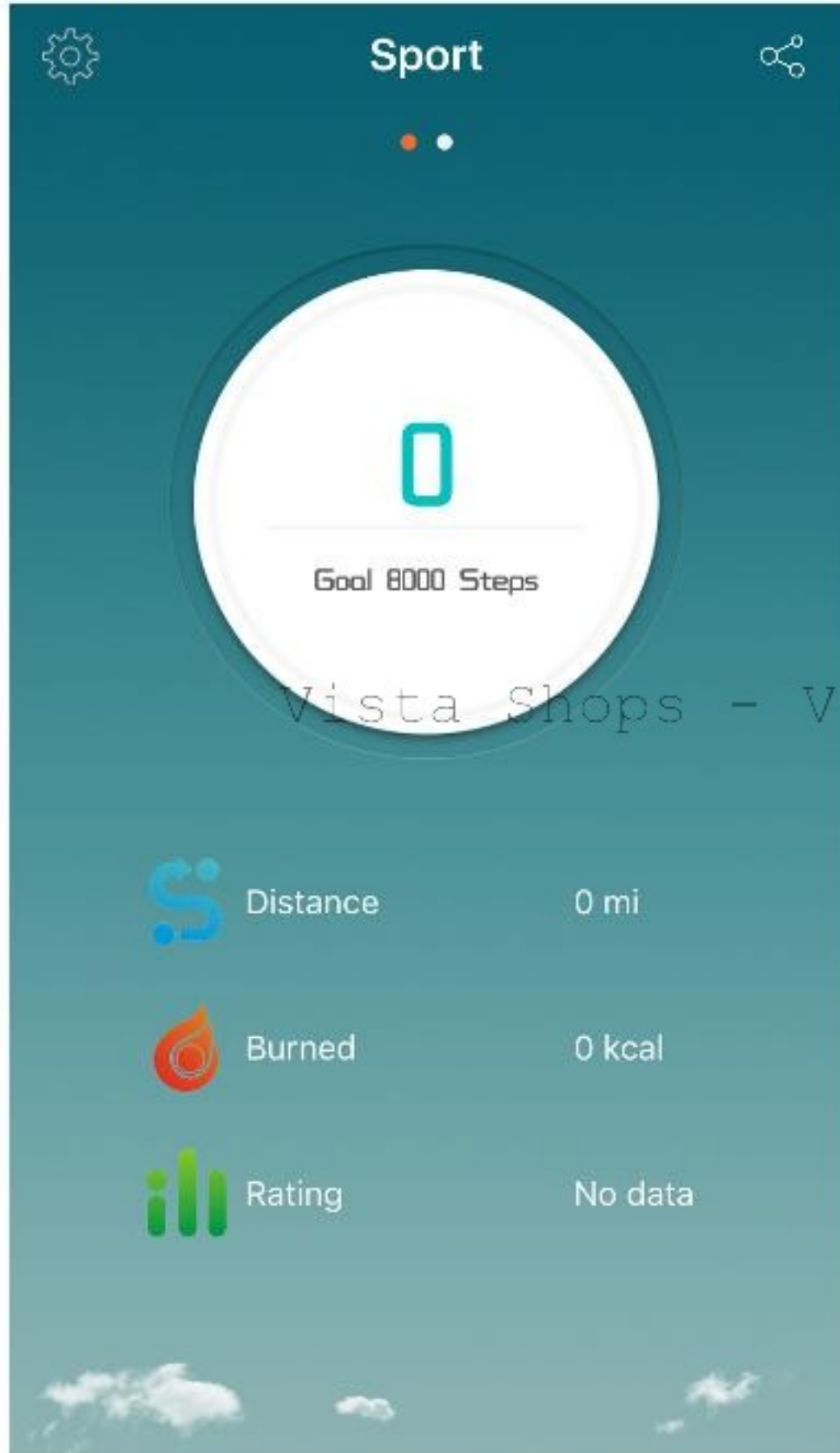
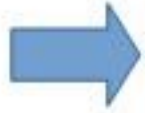

Opens the social media menu

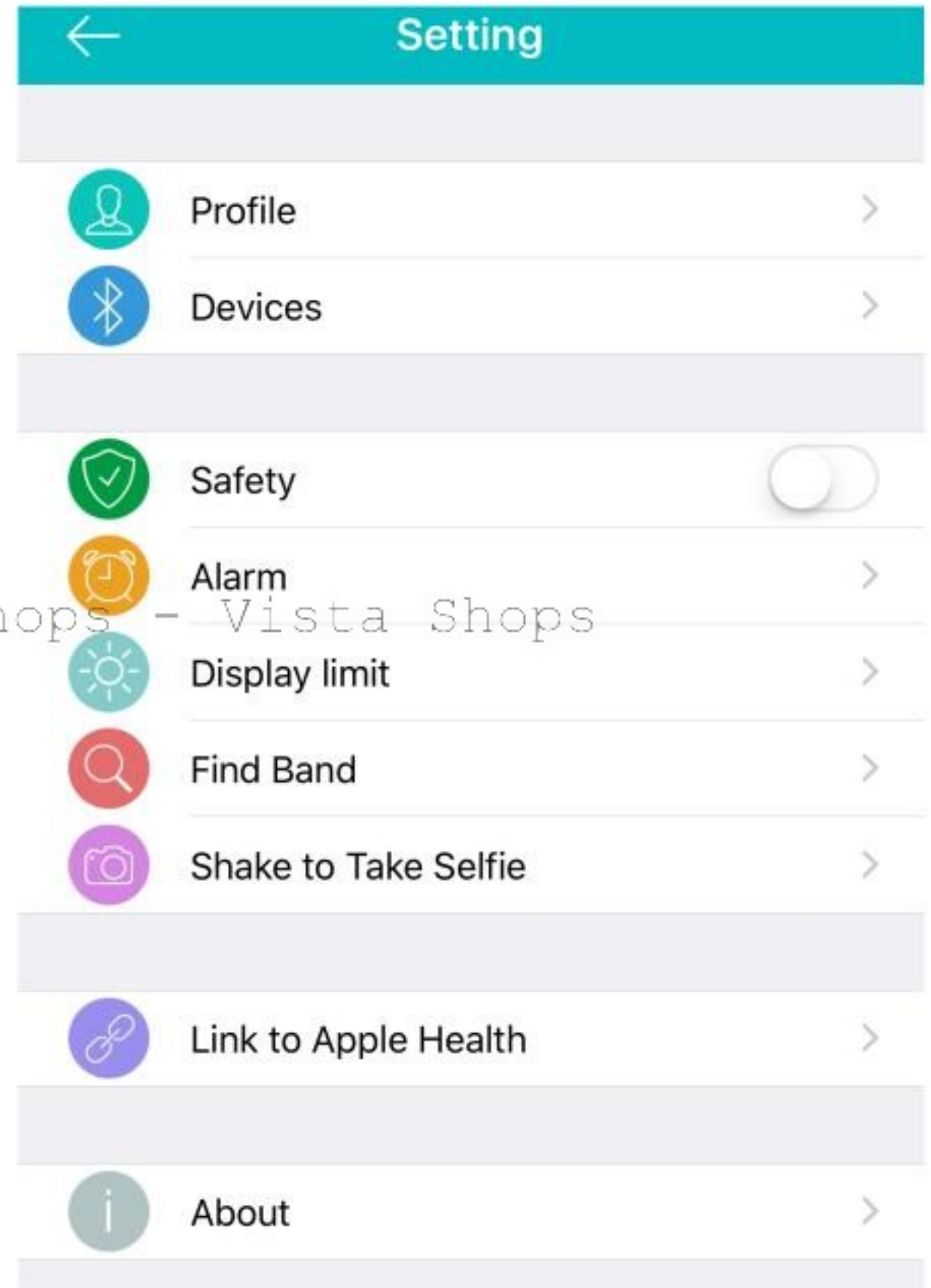

****APPLE VERSION****

Settings

Personal data that can be edited



Search for the device to be synced



Alert will go off if watch suddenly disconnects from phone.



Vista Shops

Safety



Alarm



Set up alarm alert



Watch will vibrate

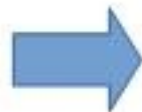

Find Band



Shake to Take Selfie

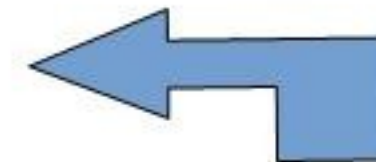

****Apple option****



Link to Apple Health



The watch can signal the camera on the phone to take a photo when shook.

About



Safety Option

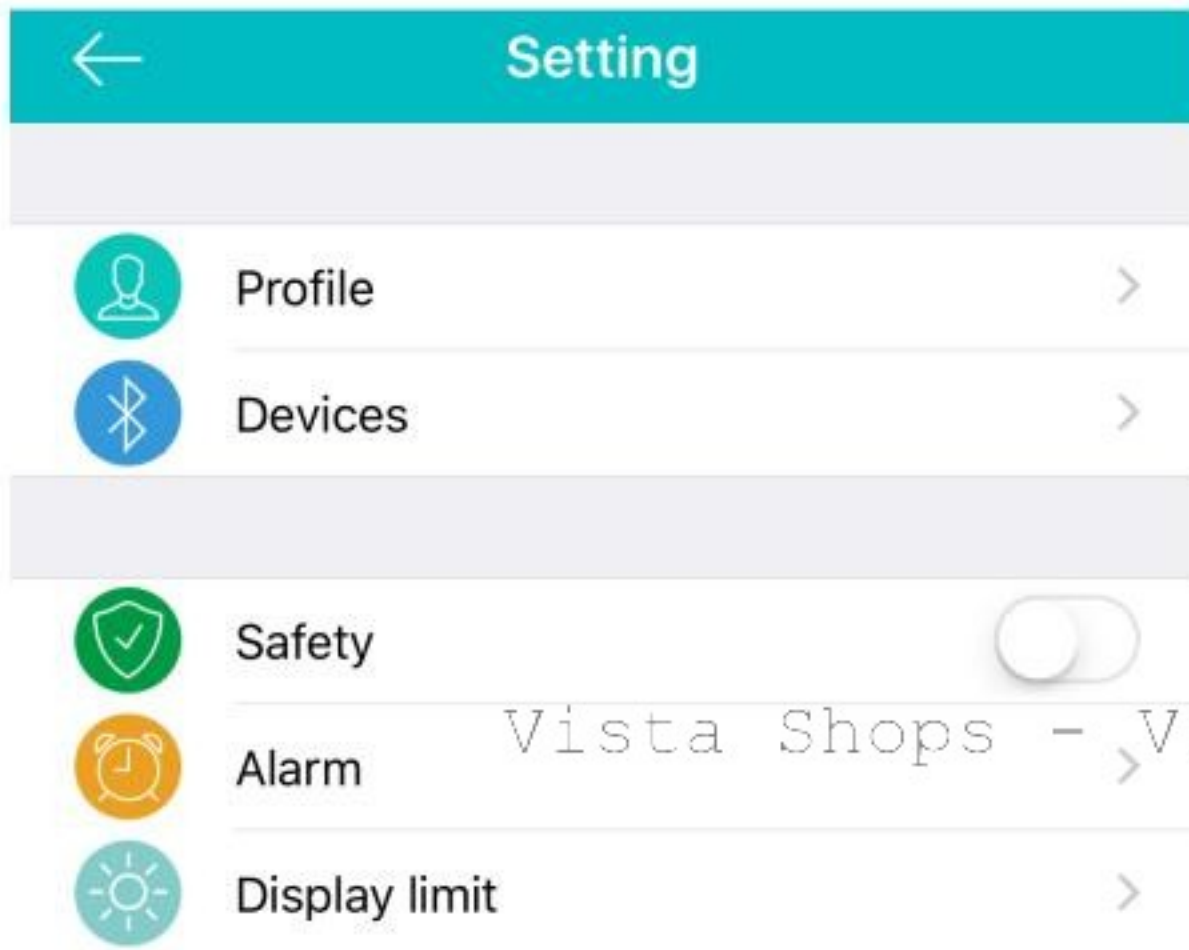

- If the watch disconnects from the phone abnormally a alarm will go off from the phone. (example: The watch leaves the range of bluetooth)

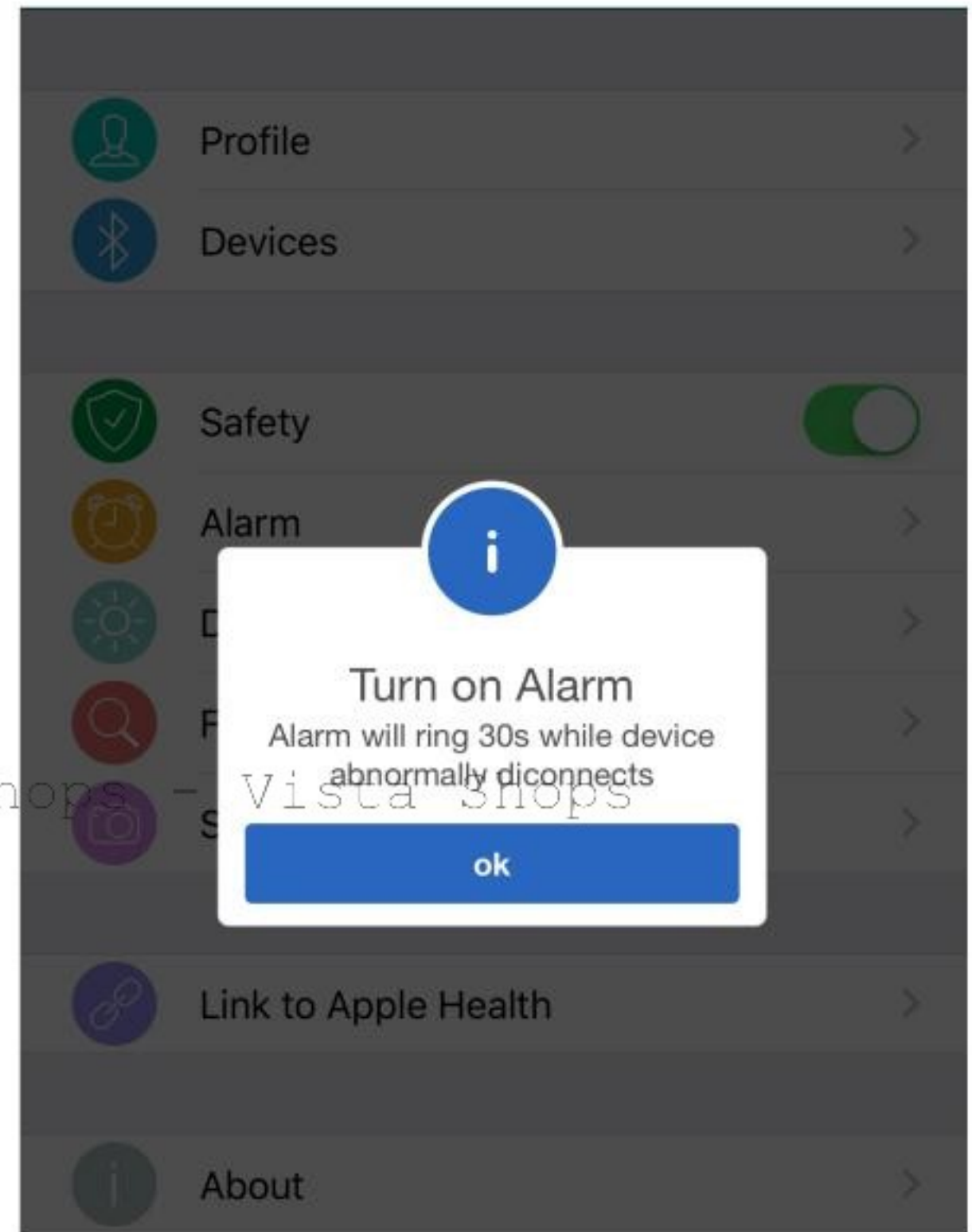

Profile

The data on Profile can be edited at anytime.

Units are not in Miles and Feet.

If the height and weight show as km and kg then please check 'Distance Unit'.

For Imperial Units (miles, pounds and inches) then set 'Distance Units' to mi.

